



CHECK VALVES



OUR GOAL IS TO PROVIDE

BEST IN CLASS

COMPACT BALL, CHECK & PIGGING VALVES THAT
MEET OR EXCEED OUR CUSTOMER'S EXPECTATIONS

Model CV Check Valve

CV Check Valve Repair Kit Part Number Code

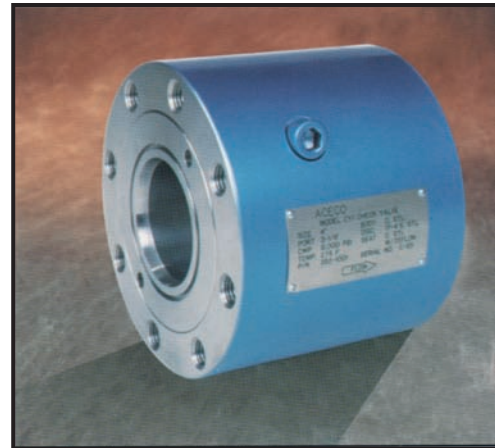
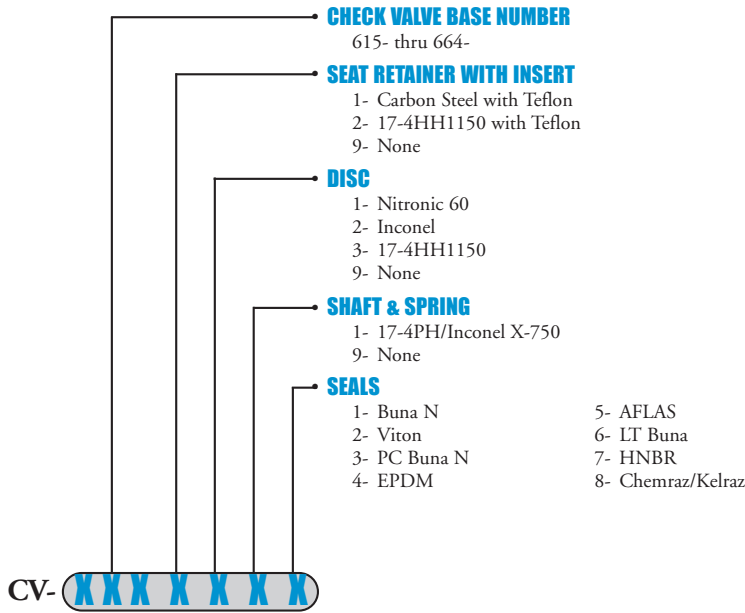

Not Shown

9 10 11 12

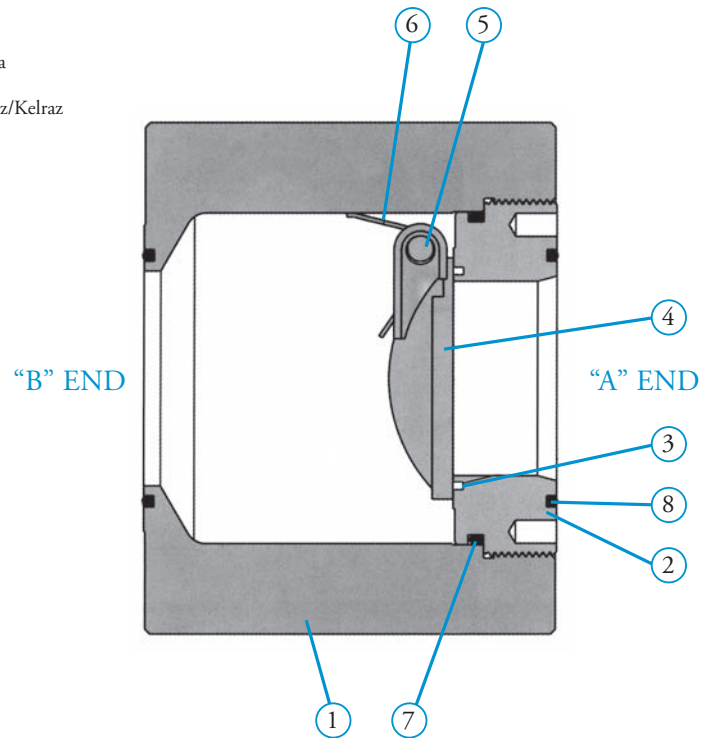

Component Parts

INDEX	REQUIRED	DESCRIPTION	MATERIAL
1	1	Body	Carbon Steel or Alloy Steel
2	1	Seat Retainer	Carbon Steel or Alloy Steel
3	1	Seat Insert	Teflon
4	1	Disc	Nitronic 60 or Incoloy
5	1	Shaft	17-4 PH Stainless Steel
6	1	Spring	Inconel X-750
7	1	Seat Retainer Seal	Buna, Viton, Peroxide Cured Buna, EPDM, AFLAS, Low Temp Buna
8	2	Face Seal	Buna, Viton, Peroxide Cured Buna, EPDM, AFLAS, Low Temp Buna
9	2	Shaft Retainer	302 Stainless Steel
10	2	Shaft Retainer Seal	Buna, Viton, Peroxide Cured Buna, EPDM, AFLAS, Low Temp Buna
11	1	End Connection Assembly- "A" End	Carbon Steel or Alloy Steel, B7 Bolting
12	1	End Connection Assembly- "B" End	Carbon Steel or Alloy Steel, B7 Bolting

Model CV Check Valve

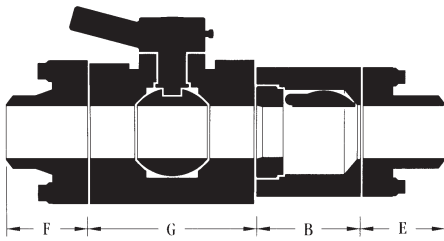
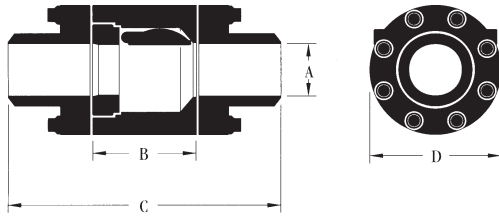

THIS COMBINATION APPLIES ONLY TO 2" MODEL BV1 BALL VALVES & 2" MODEL CV CHECK VALVES WITH 3600, 5000, & 6000 PSI WORKING PRESSURES

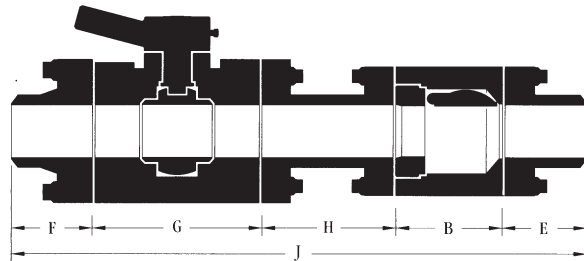

THIS COMBINATION APPLIES ONLY TO ALL OTHER MODEL BV1 & BV2 BALL VALVES & ALL MODEL CV CHECK VALVES WITH OTHER SIZES & WORKING PRESSURES

CV Working Pressure	Nominal Valve Size (mm)	Assembly Base No.	Std. End Config.	A Seat Port Size (mm)	B Body Group Length (mm)	C Weld Ends Overall (mm)	D Body Width (mm)	E Check Valve Nipple Length (mm)	F Ball Valve Nipple Length (mm)	G Ball Body Group Length (mm)	H Spool Length (mm)	J Ball & Check Weldends Overall (mm)
3705 PSI	1" (25)	615-	SLP x SLP	13/16" (21)	4" (102)	12" (305)	4-1/8" (105)	4" (102)	4" (102)	4" (102)	6" (152)	22" (559)
	2" (51)	616-	SLP x SLP	1-1/2" (38)	4" (102)	14-1/2" (368)	5-1/4" (133)	5-1/4" (133)	5-1/4" (133)	5" (127)	0 (0)	19-1/2" (495)
	3" (76)	621-	SLP x SLP	2-3/8" (60)	5" (127)	16-1/2" (419)	6-1/4" (159)	5-3/4" (146)	5-3/4" (146)	7" (178)	8" (203)	31-1/2" (800)
	4" (102)	625-	SLP x SLP	3-5/8" (92)	7" (178)	20" (508)	8" (203)	6-1/2" (127)	5" (127)	10" (254)	8-1/2" (216)	37" (940)
	6" (152)	626-	SLP x SLP	5" (127)	9" (229)	22" (559)	10" (254)	6-1/2" (127)	5" (127)	12" (305)	9" (229)	41-1/2" (1,054)
	8" (203)	650-	SLP x SLP	7-1/16" (179)	12" (305)	26" (660)	14-1/4" (362)	7" (178)	7" (178)	15" (381)	12" (305)	53" (1,346)
	10" (254)	652-	WNF x WNF	8-1/2" (216)	15" (381)	30" (762)	16-3/4" (425)	7-1/2" (191)	7-1/2" (191)	17" (432)	12" (305)	59" (1,499)
5000/6000 PSI	1" (25)	615-	SLP x SLP	13/16" (21)	4" (102)	12" (305)	4-1/8" (105)	4" (102)	4" (102)	4" (102)	6" (152)	22" (559)
	2" (51)	616-	SLP x SLP	1-1/2" (38)	4" (102)	14-1/2" (368)	5-1/4" (133)	5-1/4" (133)	5-1/4" (133)	5" (127)	0	19-1/2" (495)
	3" (76)	621-	SLP x SLP	2-3/8" (60)	5" (127)	16-1/2" (409)	6-1/4" (159)	5-3/4" (146)	5-3/4" (146)	7" (178)	8" (203)	31-1/2" (800)
	4" (102)	624-	SLP x SLP	3-1/8" (79)	6-1/2" (165)	19-1/2" (495)	8" (203)	6-1/2" (127)	5" (127)	10" (254)	8" (203)	36" (914)
	6" (152)	628-	SLP x SLP	5" (127)	10" (254)	23" (584)	11-1/2" (292)	6-1/2" (165)	6-1/2" (165)	13" (330)	12" (305)	48" (1,219)
	8" (203)	650-	SLP x SLP	7-1/16" (179)	12" (305)	26" (660)	14-1/4" (362)	7" (178)	7" (178)	15" (381)	12" (305)	53" (1,346)
	10" (254)	654-	WNF x WNF	8-1/2" (216)	15" (381)	30" (762)	17-1/4" (438)	7-1/2" (191)	7-1/2" (191)	17" (432)	12" (305)	59" (1,499)
10,000 PSI	1" (25)	629-	SLP x SLP	13/16" (21)	4" (102)	12" (305)	4-1/8" (105)	4" (102)	4" (102)	4" (102)	6" (152)	22" (559)
	2" (51)	630-	SLP x SLP	1-1/2" (38)	5-1/2" (140)	16" (406)	5-7/8" (149)	5-1/4" (133)	5-1/4" (133)	5-1/2" (140)	7-1/2" (191)	29" (737)
	3" (76)	633-	WNF x WNF	2-3/4" (70)	8" (203)	18" (457)	8-3/4" (222)	5" (127)	5" (127)	8" (203)	9" (229)	35" (889)
	4" (102)	634-	WNF x WNF	3-1/16" (78)	8" (203)	18" (457)	8-3/4" (222)	5" (127)	5-1/2" (140)	9" (229)	9-1/2" (241)	37" (940)
	6" (152)	635-	SLP x SLP	4-1/16" (103)	10" (254)	23" (584)	11-1/2" (292)	6-1/2" (165)	6-1/4" (159)	12" (305)	13" (330)	47-3/4" (1,213)
	8" (203)	661-	WNF x WNF	6.225" (158)	12" (305)	28" (711)	14-1/2" (368)	8" (203)	8" (203)	15" (381)	12" (305)	55" (1,397)
	10" (254)	662-	WNF x WNF	7-3/4" (197)	14" (356)	32" (813)	17-1/4" (438)	9" (229)	8" (203)	17" (432)	-	-
15,000 PSI	1" (25)	637-	WNF x WNF	13/16" (21)	4" (102)	10" (254)	4-1/8" (105)	3" (76)	3" (76)	4-3/4" (121)	-	-
	2" (51)	638-	WNF x WNF	1-3/8" (35)	5-1/2" (140)	14-1/2" (368)	7.20" (183)	4-1/2" (114)	4-1/2" (114)	7" (178)	-	-
	3" (76)	640-	WNF x WNF	1.938" (49)	6" (152)	15" (381)	8-1/2" (216)	4-1/2" (114)	4-1/2" (114)	9" (229)	-	-
	4" (102)	642-	WNF x WNF	2-5/8" (67)	8" (203)	19-1/2" (495)	11-1/4" (286)	5-3/4" (146)	5-3/4" (146)	10-1/2" (267)	-	-
	6" (152)	644-	WNF x WNF	3-3/4" (95)	11-1/2" (292)	24" (607)	14-1/2" (368)	6-1/4" (159)	6-1/4" (159)	11-1/2" (282)	-	-
	8" (203)	646-	WNF x WNF	5-1/2" (140)	12-7/8" (327)	25-3/8" (645)	16-1/2" (419)	6-1/4" (159)	7" (178)	13-1/2" (343)	-	-

Models CV Check Valve Assembly Part Numbers

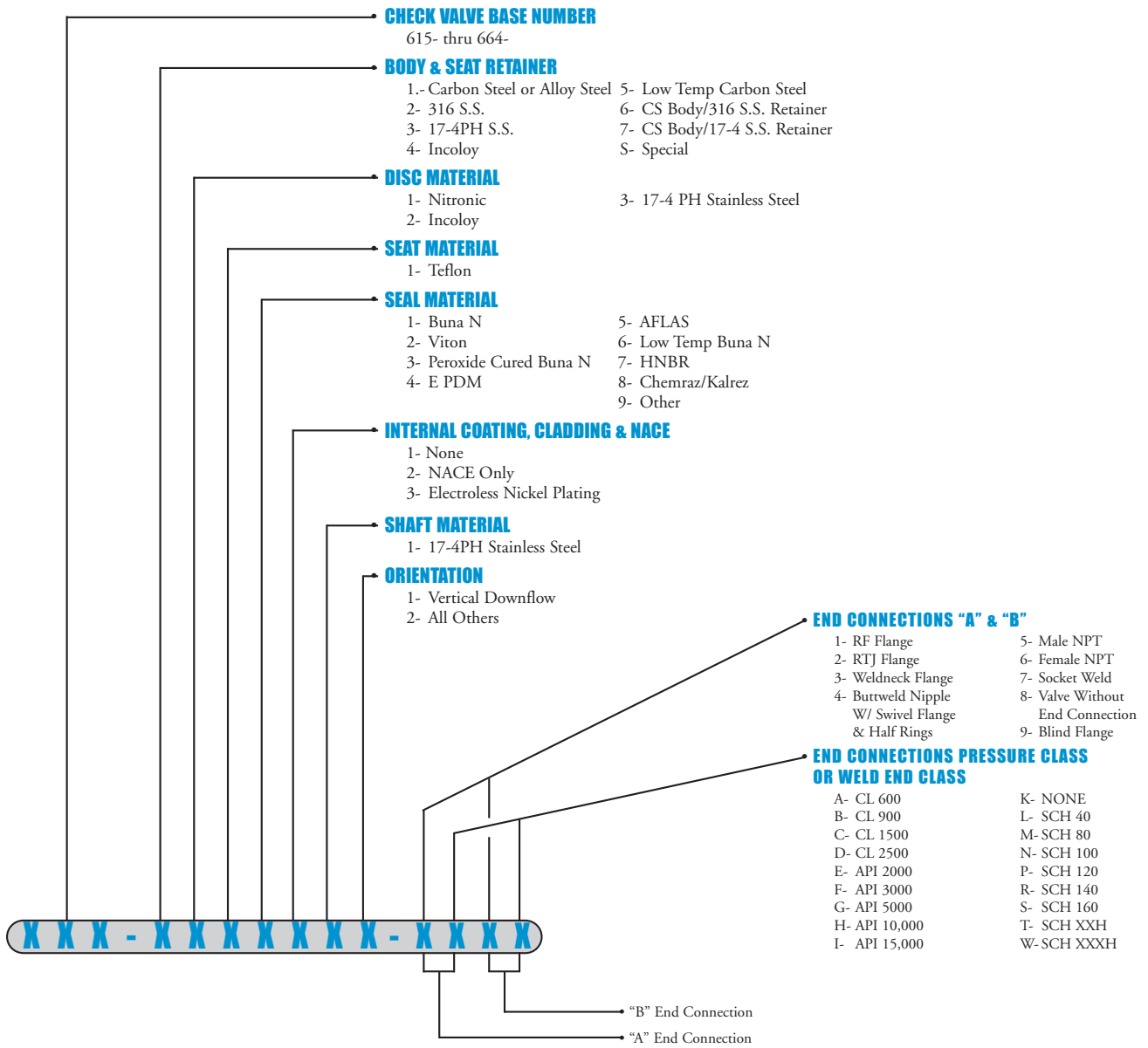

WORKING PRESSURE		1"	2"	3"	4"	6"	8"	10"	12"
3705 PSI	Size x Bore	1" x 13/16"	2" x 1-1/2"	3" x 2-3/8"	4" x 3-5/8"	6" x 5"	8" x 7-1/16"	10" x 8-1/2"	12" x 9-3/4"
	Base No.	615-	616-	621-	625-	626-	650-	652-	663-
5000 PSI	Size x Bore	1" x 13/16"	2" x 1-1/2"	3" x 2-3/8"	4" x 3-1/8"	6" x 5"	8" x 7-1/16"	10" x 8-1/2"	12" x 9-3/4"
	Base No.	615-	616-	621-	624-	628-	650-	654-	664-
6000 PSI	Size x Bore	1" x 13/16"	2" x 1-1/2"	3" x 2-3/8"	4" x 3-1/8"	6" x 5"	8" x 7-1/16"	10" x 8-1/2"	12" x 9-3/4"
	Base No.	615-	616-	621-	624-	628-	650-	654-	664-
10,000 PSI	Size x Bore	1" x 13/16"	2" x 1-1/2"	3" x 2-3/4"	4" x 3-1/16"	6" x 4-1/16"	8" x 6.22"	10" x 7-3/4"	12" x 9-3/4"
	Base No.	629-	630-	633-	634-	635-	661-	662-	664-
15,000 PSI	Size x Bore	1" x 13/16"	2" x 1-3/8"	3" x 1-15/16"	4" x 2-5/8"	6" x 3-3/4"	8" x 5-1/2"	-	-
	Base No.	637-	638-	640-	642-	644-	646-	-	-